

This drawing must NOT be scanned. Prior to the commencement of any works, the Main Contractor is to check and/or determine all construction details including checking existing site levels and dimensions. This drawing is to be read in conjunction with all other project drawings, construction notes and/or project specifications. All discrepancies should be reported to the Architect immediately.

RISK ANALYSIS KEY	 Indicates a residual risk as a warning.
-------------------	---

SAFETY, HEALTH & ENVIRONMENTAL INFORMATION	In addition to the hazards/risks normally associated with the type of work detailed on this drawing, please note the following:
It is assumed that all works will be carried out by a competent contractor working, where appropriate, to an approved method statement	

For Setting Out Details Refer to HGP Drawing No. 13.168.A(90)00\_02

For Setting Out Details Refer to HGP Drawing No. 13.168.A(90)00\_03

For Setting Out Details Refer to HGP Drawing No. 13.168.A(90)00\_04

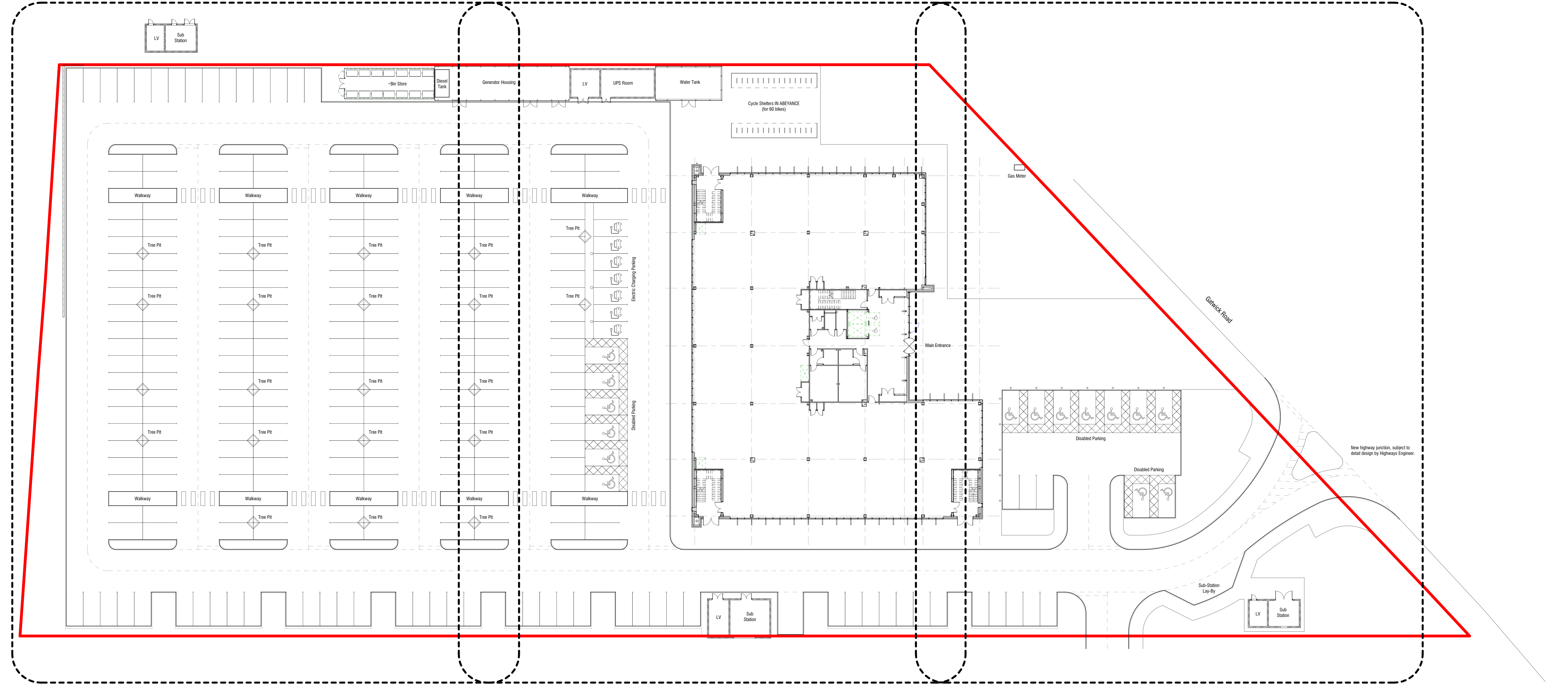

**Notes**

- All consultants must check this information prior to implementation and report any co-ordination discrepancies to the Architect immediately.
- For details of all sub-bases, drainage, foundations, structural floor slabs and steel frame, please refer to Structural Engineer's drawings and specifications.
- For details of the proposed Mechanical and Electrical installation, including external lighting, CCTV and duct routes, please refer to the MAE Consultant's drawings and specifications.
- For details of the proposed hard and soft landscaping, please refer to the Landscape Architects drawings and specifications.
- Drawing to be read in conjunction with all other General Arrangement drawings, sections and elevations.
- All specification items noted and dimensioned are subject to final confirmation and detailed design input between the Architect, Structural Engineer, MSE Consultant, Main Contractor and specialist sub-contractors.

**Parking Schedule**

Standard Parking Space (2400 x 4800mm) -	263No. spaces
Disabled Parking Space (3600 x 6000mm) -	15No. spaces
Electric Vehicle Parking Space (2400 x 4800mm) -	7No. spaces
<b>TOTAL</b>	<b>275No. spaces</b>

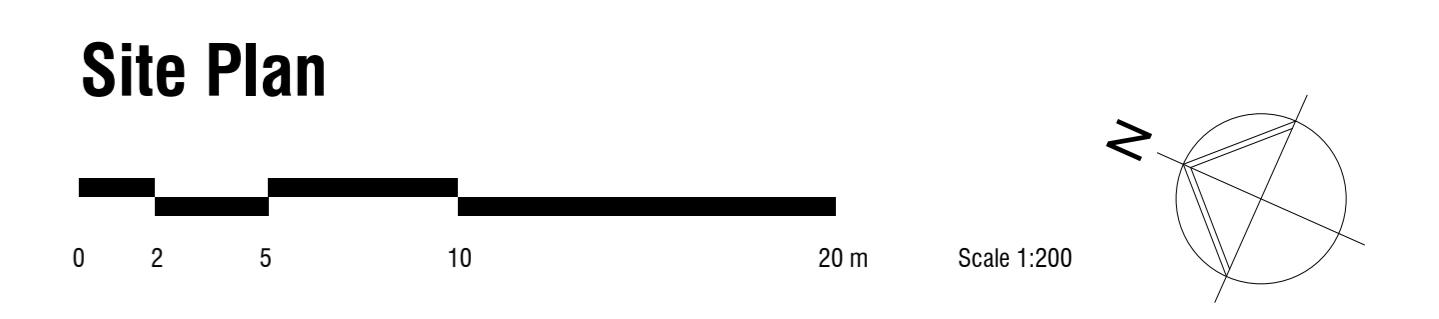

No	Date	Description	By	For
K	14.04.16	General update	SAK	LM
J	10.12.15	Sub-Stations amended and Generator Housing added.	HSP	LM
H	30.11.15	Large areas of end of parking bays amended and parking numbers added to end.	HSP	LM
G	23.09.15	Minor amendments withdrawn from the scheme. Accessible parking area to Main Reception re-located. Fire exit doors from Open Plan Office moved to East and West ends.	HSP	LM

**NOTES:**

**CONSTRUCTION**

CLIENT  
**WILLMOTT DIXON**

THE  
**FORMER THALES SITE**

Site Plan

**HGP** ARCHITECTS  
 FURZEHALL FARM, WICKHAM ROAD  
 FAREHAM, HAMPSHIRE, PO16 2JH  
 T. 01329 283 225

**LEEDS OFFICE**  
 CALLS WHARF, 2 THE CALLS  
 LEEDS, LS2 7JF  
 T. 0113 237 2750

HGP ARCHITECTS LTD.  
 Copyright Reserved  
 Check date on site.